



Sanctus Court, Stratford-Upon-Avon, CV37 6DL

**SHELDON
BOSLEY
KNIGHT**

LAND AND
PROPERTY
PROFESSIONALS

Property Description

*** UNDER APPLICATION *** A two bedroom ground floor apartment, freshly painted and re-carpeted throughout. A short walk through Old Town into Stratford's Town Centre. Accommodation includes a hallway with cupboard off, modern kitchen with fold down breakfast bar, Living room with fireplace and door out onto the communal gardens, 2 bedrooms and a shower room. This home is offered unfurnished and is neutrally decorated throughout. Externally there is residents parking, a garage and beautifully maintained communal gardens. Council Tax Band C. Energy Rating D.





Ground Floor

Approx. 69.4 sq. metres (747.5 sq. feet)

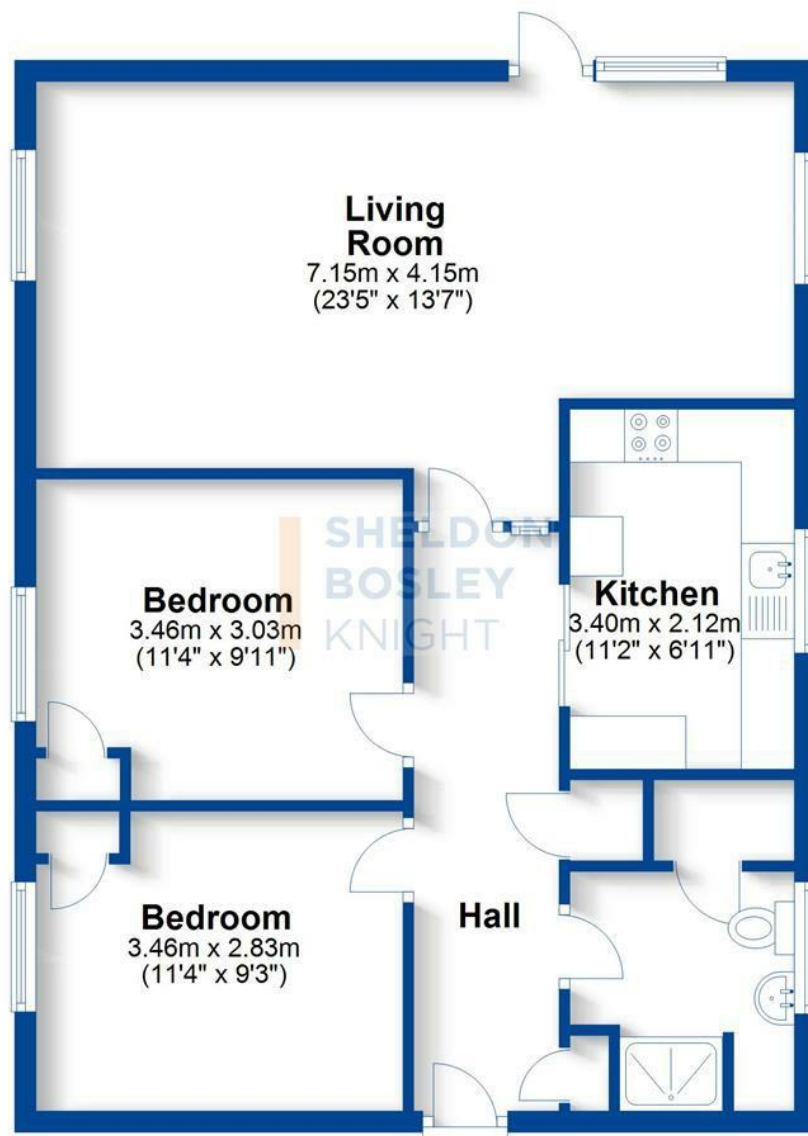

Total area: approx. 69.4 sq. metres (747.5 sq. feet)

This plan is for illustration purposes only and should not be relied upon as a statement of fact
Property of Sheldon Bosley Knight Limited. Not to be reproduced

Key Features

- *** AVAILABLE NOW ***
- Stratford upon Avon
- Two Bedrooms
- Ground Floor Apartment
- Unfurnished
- Communal gardens
- Garage & Residents parking
- Council Tax Band C
- Energy Rating D
- Walking distance of Town Centre

£850 PCM